

SAFETY AND OPERATING MANUAL

**20V Multi-Function
Inflator**

**WX092
WX092.X**

PRODUCT SAFETY

GENERAL SAFETY WARNINGS



WARNING Read all safety warnings and all instructions. Failure to follow the warnings and instructions may result in electric shock, fire and/or serious injury. Save all warnings and instructions for future reference.

- This appliance is not intended for use by persons (including children) with reduced physical, sensory or mental capabilities, or lack of experience and knowledge, unless they have been given supervision or instruction concerning use of the appliance by a person responsible for their safety.
- Children should be supervised to ensure that they do not play with the appliance.

ADDITIONAL SAFETY RULES FOR CORDLESS AIR PUMP

1. Avoid using the pump at temperatures below -25 °C or above 45 °C
2. Never leave the pump

unsupervised while it is in use.

3. Ensure that the ON/OFF switch is turned off when connecting to the power source.
4. Caution! Operate the pump only for a short time. Under the high working pressure of 8 bar (120 psi), The appliance may overheat if operated continuously for longer than 2.5 minutes. Switch the appliance off immediately and allow it to cool down for at least 7.5 minutes
5. Risk of injury! Do not pump any objects up to more than the intended pressure. They could burst and cause injury and/or material damage
6. Do not exceed the permissible output range of the pump. Do not pump up any lorry, tractor or other large tires
7. Do not work with any materials that are or could be easily inflammable or explosive.
8. Never use the pump and accessories for purposes other than the ones for which it was designed
9. The pump must be

- protected from moisture.
10. Before each use, check the device. If damage is detected, do not use the device. Have repairs performed only by a qualified technician. Never open the device yourself.
 11. The device produces a high pressure. Do not direct the air outlet at persons or animals.
 12. Remain alert at all times! Never use the appliance when you are distracted or do not feel well
 13. High pressure air could result in death or serious injury. Never operate above maximum operating pressure. Do not operate with pressure switch or safety valve set above maximum allowable working pressure.
 14. Inhalation hazard. Using pump to supply breathing air could result in death or serious injury. Do not use pump to supply breathing air.
 15. The equipment and packaging material are not toys. Do not let children play with plastic bags, foils or small parts. There is a

danger of swallowing or suffocating.

SAFETY WARNING FOR LED LAMP



WARNING: The LED lamp equipped with power tool is in the Exempt Group. In order to avoid the viewer-related risk, operator shall be more careful and read all safety warnings and all instructions. Failure to follow the warnings and instructions may result in optical injuries.

How to avoid exposure hazard

With increasing distance from a lamp the applicable hazard values decrease - see Figure 1. At the distance X_1 , $EHV = 1$, i.e. the EHV equals the applicable emission limit value. Distance X_1 is the hazard distance (HD) for this lamp system. At distance X_2 , the optical radiation hazard value exceeds the applicable emission limit value by a factor of A . At this distance, excessive exposure to optical radiation may be reduced either by restricting exposure time by a factor of A (if the emission limit values are expressed in terms of radiant

exposure or time integrated radiance), or by using engineering controls (such as filters) which attenuate the accessible emission and/or personal protective means (such as eyewear, clothing) which would limit the potential exposure to the emitted energy.

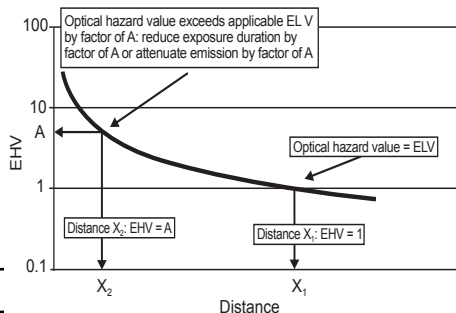

Figure 1 – Example of graphic presentation of distant dependent emission hazard values

SAFETY WARNINGS FOR BATTERY PACK

- a) Do not dismantle, open or shred cells or battery pack.**
- b) Do not short-circuit a battery pack. Do not store battery packs haphazardly in a box or drawer where they may short-circuit each other or be short-circuited by**

conductive materials.

When battery pack is not in use, keep it away from other metal objects, like paper clips, coins, keys, nails, screws or other small metal objects, that can make a connection from one terminal to another. Shorting the battery terminals together may cause burns or a fire.

- c) Do not expose battery pack to heat or fire. Avoid storage in direct sunlight.**
- d) Do not subject battery pack to mechanical shock.**

- e) In the event of battery leaking, do not allow the liquid to come into contact with the skin or eyes. If contact has been made, wash the affected area with copious amounts of water and seek medical advice.**
- f) Keep battery pack clean and dry.**
- g) Wipe the battery pack terminals with a clean dry cloth if they become dirty.**
- h) Battery pack needs to be charged before use.**

Always refer to this instruction and use the correct charging procedure.

- i) Do not maintain battery pack on charge when not in use.**
- j) After extended periods of storage, it may be necessary to charge and discharge the battery pack several times to obtain maximum performance.**
- k) Recharge only with the charger specified by Worx . Do not use any charger other than that specifically provided for use with the equipment.**
- l) Do not use any battery pack which is not designed for use with the equipment.**
- m) Keep battery pack out of the reach of children.**
- n) Retain the original product literature for future reference.**
- o) Remove the battery from the equipment when not in use.**
- p) Dispose of properly.**
- q) Do not mix cells of different manufacture, capacity, size or type**

within a device.

- r) Keep the battery away from microwaves and high pressure.**

SAFETY POINTS FOR YOUR FLASHLIGHT/ WORKLIGHT SAFETY RULES FOR CORD-LESS PORTABLE HAND-HELD LIGHT

CHARGE BATTERY BEFORE FIRST USE

CAUTION: Read, understand and follow all Safety Rules and Operating Instructions in this Manual before using this product.

SAVE THESE INSTRUCTIONS! READ ALL INSTRUCTIONS!

SAFETY INSTRUCTIONS

WARNING: Be sure to read  and understand all instructions in this manual before using this portable hand-held light. Failure to follow all instructions may result in electric shock, fire and/or serious personal injury.

- 1. Know your cordless portable hand-held light.**

Read operator's manual carefully.

Learn its applications and limitations, as well as the specific potential hazards related to this light.

2. **Use only recommended battery pack and charger.**

Any attempt to use another battery pack will cause damage to the portable hand-held light and could possible explode, cause a fire, or personal injury.

Note : For specific information about battery pack and charger ,please refer to Table 1 in this manual.

3. **Remove battery pack from portable hand-held light before replacing bulb or performing any routine maintenance or cleaning.**

4. Let portable hand-held light cool for several minutes after use before changing the bulb.

5. Do not disassemble the portable hand-held light.

6. Do not place portable hand-held light or battery pack near fire or heat. They may explode. Also, do not dispose of a worn out battery pack

by incineration, even if it is severely damaged or completely worn out. The battery may explode in fire.

7. **Do not operate portable hand-held light or charging stand/ transformer near flammable liquids or in gaseous or explosive atmospheres.** Internal sparks may ignite fumes.







8. **To reduce the risk of electric shock, do not put portable hand-held light in water or other liquid.** Do not place or store portable hand-held light where it can fall or be pulled into a tub or sink.









9. **Do not permit children to use portable hand-held light unsupervised. It is not a toy.** The temperature of the bulb will become hot after being on only a short period of time. This hot temperature can cause burn injury if touched.

10. **DO NOT USE OR PERMIT USE OF PORTABLE HAND-HELD LIGHT IN BED OR SLEEPING BAGS. This portable hand-held light lens can melt fabric and a burn injury could result.**

11. **Keep light dry, clean, and free from oil and grease.** Always use a clean cloth when cleaning. Never use brake fluid, gasoline, petroleum-base products or any strong solvent to clean the portable hand-held light.
12. **The light source of this luminaire is not replaceable;** when the light source reaches its end of life the whole luminaire shall be replaced.

SYMBOL

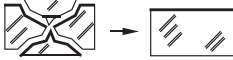
	To reduce the risk of injury, user must read instruction manual
	Warning
	Wear eye protection
	Hearing protection must be worn
	Risk of high temperature
	Waste electrical products must not be disposed of with household waste. Please recycle where facilities exist. Check with your local authorities or retailer for recycling advice.

	Li-Ion battery. This product has been marked with a symbol relating to 'separate collection' for all battery packs and battery pack. It will then be recycled or dismantled in order to reduce the impact on the environment. Battery packs can be hazardous for the environment and for human health since they contain hazardous substances
	
	
	
	Batteries may enter water cycle if disposed improperly, which can be hazardous for ecosystem. Do not dispose of waste batteries as unsorted municipal waste
	Do not burn
	Class III
	Replace any cracked protective shield
	RCM marking
	ABN: Australian Business Number. By this number, business information such as entity type, status, business location etc. can be found at website http://abr.business.gov.au . ABN of Positec Australia Pty Limited is 14 101 682 357

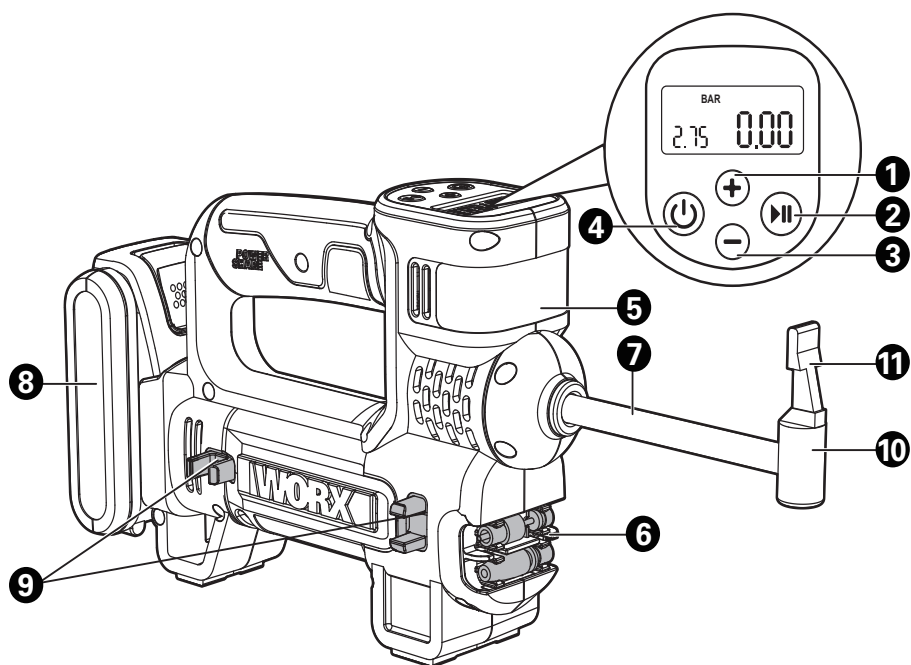

**20V Multi-Function
Inflator**

**WX092
WX092.X**

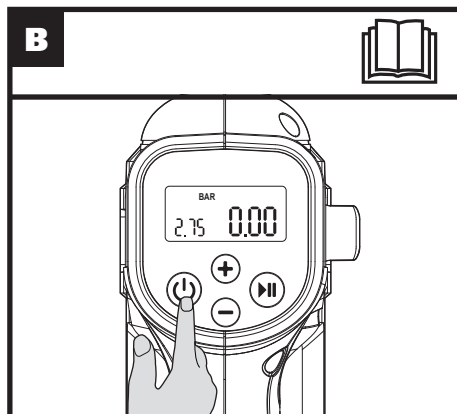
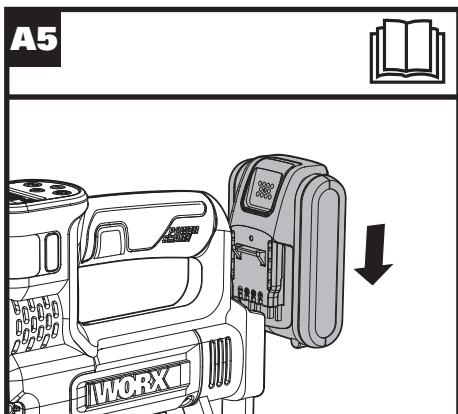
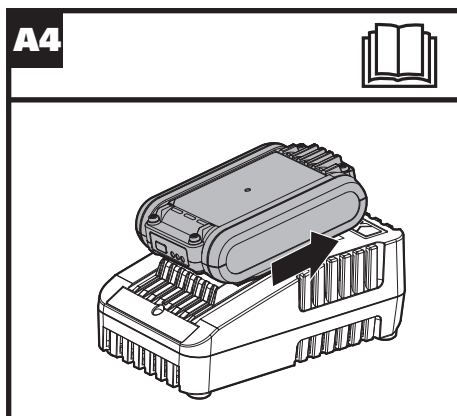
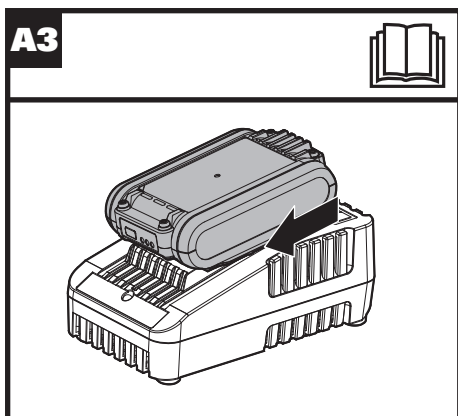
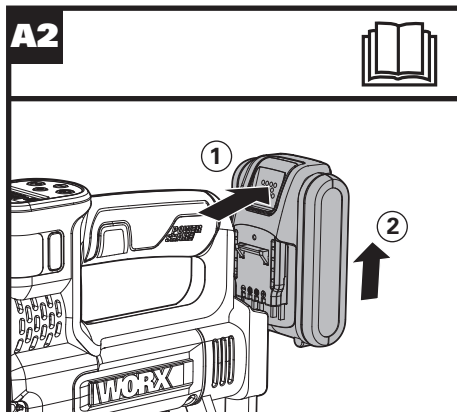
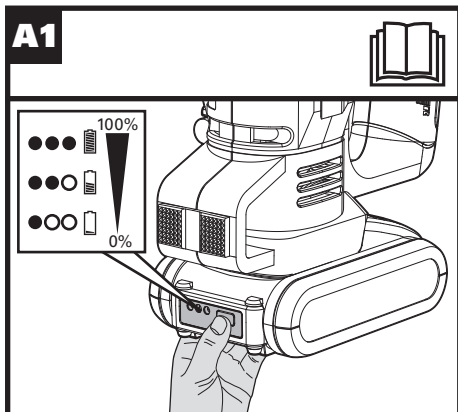

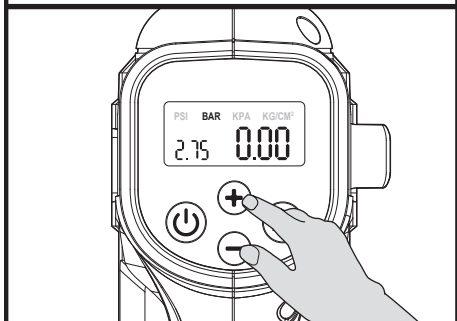
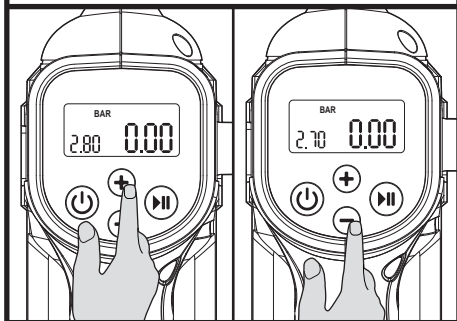
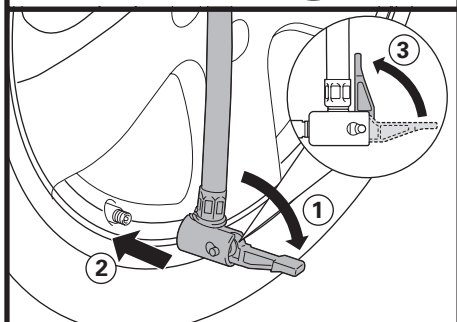
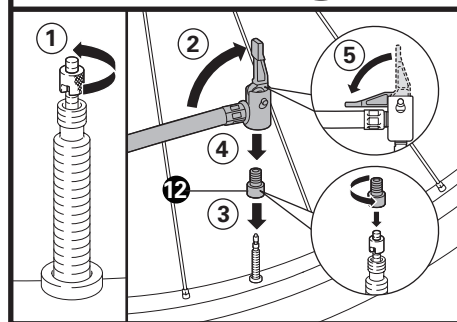
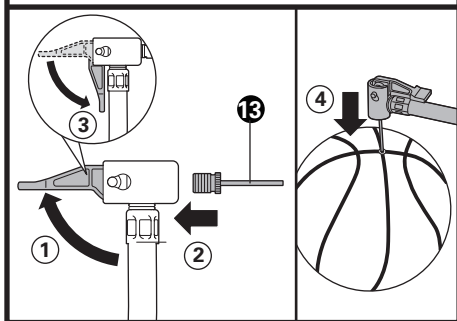
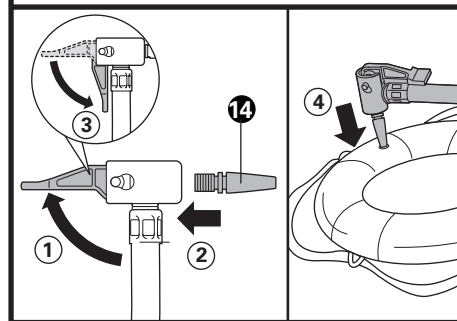
C**D****E1****E2****E3****E4**

**20V Multi-Function
Inflator**

**WX092
WX092.X**

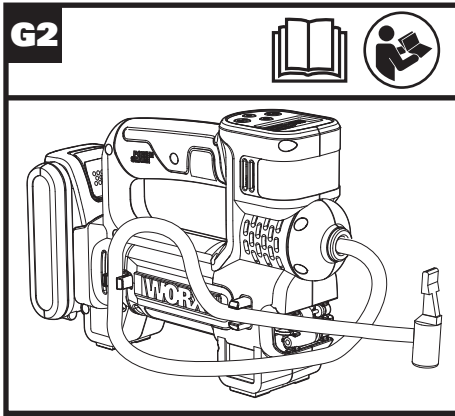
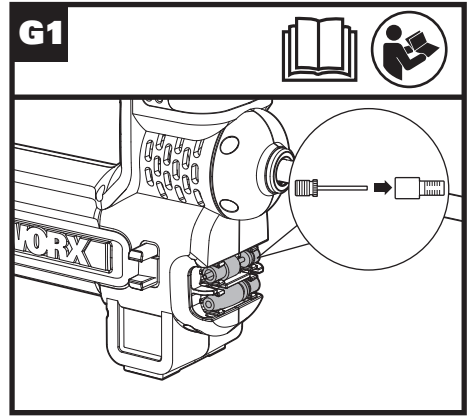
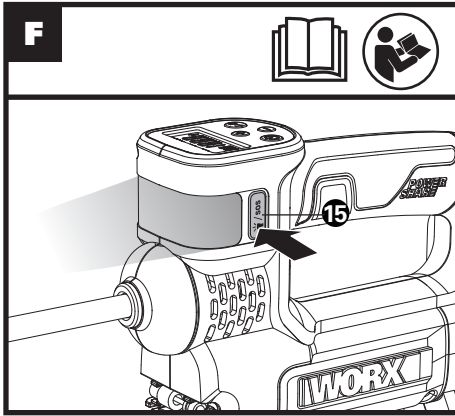

COMPONENT LIST

1.	INCREASE AIR PRESSURE BUTTON
2.	START/STOP BUTTON
3.	DECREASE AIR PRESSURE BUTTON
4.	POWER BUTTON
5.	WORKLIGHT
6.	ADAPTER HOLDER
7.	HOSE
8.	BATTERY PACK*
9.	HOSE CLAMP
10.	AIR CHUCK
11.	AIR CHUCK CLAMP
12.	PRESTA VALVE ADAPTER(SEE FIGURE E2)
13.	SPORT BALL NEEDLE(SEE FIGURE E3)
14.	TAPERED ADAPTER (SEE FIGURE E4)
15.	WORKLIGHT BUTTON (SEE FIGURE F)

12 *Not all the accessories illustrated or described are included in standard delivery

TECHNICAL DATA

	WX092 WX092.X***
Rated voltage	20 V === Max**
Inflation efficiency (0 to 2.4 bar for 215/55R17 tires)	4 mins
Working pressure	10 bar(150 psi) Max 8 bar (120 psi) 2.5 mins/7.5 mins
Weight (Bare tool)	0.95 kg

** Voltage measured without workload. Initial battery voltage reaches maximum of 20 volts. Nominal voltage is 18 volts.

*** X=1-999, A-Z, M1-M9 there are only used for different customers, there are no safe relevant changes between these models

SUGGESTED BATTERIES AND CHARGERS

Category	Model	Capacity
20V Battery	WA3550	1.5 Ah
	WA3550.1	1.5 Ah
	WA3551	2.0 Ah
	WA3551.1	2.0 Ah
20V Charger	WA3553	4.0 Ah
	WA3760	0.4 A
	WA3869	2.0 A
	WA3880	2.0 A

We recommend that you purchase your accessories from the same store that sold you the tool. Refer to the accessory packaging for further details. Store personnel can assist you and offer advice.

OPERATING INSTRUCTIONS



NOTE: Before using the tool, read the instruction book carefully.

INTENDED USE



This product is a multifunctional device, combining inflators, tire pressure monitor, lighting, SOS warning four functions in one.

ASSEMBLY AND OPERATION

ACTION	FIGURE
BEFORE OPERATION	
Checking the Battery Pack Condition NOTE: Fig. A1 only applies for the battery pack with battery indicator light.	See Fig. A1
Removing the Battery Pack	See Fig. A2
Charging the Battery Pack	See Fig. A3,A4
Installing the Battery Pack	See Fig. A5
OPERATION	

20V Multi-Function Inflator

WX092
WX092.X

Power button Press the button to turn on the tool and hold the button to turn it off. NOTE: To avoid unintentional start up, the power button will automatically shut down when the Start/Stop button is not pressed for a certain period after the power button is turned on.	See Fig. B
Changing the unit of measure Press INCREASE AIR PRESSURE BUTTON and DECREASE AIR PRESSURE BUTTON simultaneously to change the unit of measure	See Fig. C
Setting the pressure Press INCREASE AIR PRESSURE BUTTON or DECREASE AIR PRESSURE BUTTON to set the pressure value. NOTE: Object's original air pressure will be displayed once connected. Without connection, "0" will be displayed.	See Fig. D
Inflating Connect the object to the tool. Then press Start/Stop button. Once it reaches the set pressure, the tool will automatically stop. NOTE: Make sure all connections have been tightened before inflating. NOTE: In E2, loosen the locking nut on the valve stem first.  WARNING: When inflating the floating tube, check the status of the tube rather than using the pressure value on the gauge.	See Fig. E1, E2, E3, E4
Work Light Press the work light button to cycle through work light or SOS emergency light.  WARNING: Do not look towards the light directly.	See Fig. F
Storing adapter and hose	See Fig. G1, G2

Battery protection system

The tool is equipped with a battery protection system. The system will automatically cut off power to the tool to extend battery life. The tool will automatically stop during operation if the battery is placed under one of the following conditions:

- **Overloaded:** The tool is operated in a manner that causes it to draw an abnormally high current. In this situation, turn the tool off and stop the application that caused the tool to become overloaded. Then turn the tool on to restart.
- **Low battery voltage:** The remaining Battery capacity is too low and the tool will not operate. In this situation, remove and recharge the Battery.

MAINTENANCE

Remove the battery pack from the tool before carrying out any adjustment, servicing or maintenance.

Your power tool requires no additional lubrication or maintenance.
There are no user serviceable parts in your power tool. Never use water or chemical cleaners to clean your power tool. Wipe clean with a dry cloth. Always store your power tool in a dry place. Keep the motor ventilation slots clean. Keep all working controls free of dust. Occasionally you may see sparks through the ventilation slots. This is normal and will not damage your power tool.

Positec Australia Pty Limited

10 Corporate Blvd Bayswater, VIC 3153, Australia

ENVIRONMENTAL PROTECTION



Waste electrical products must not be disposed of with household waste. Please recycle where facilities exist. Check with your local authorities or retailer for recycling advice.

DECLARATION OF CONFORMITY

We,
Positec Germany GmbH
Postfach 32 02 16, 50796 Cologne, Germany

Declare that the product,
Description **Cordless air pump**
Type Designation **WX092 WX092.X (092-designation of machinery, representative of Cordless air pump)**
Function **Inflating**

Complies with the following directives,
2014/35/EU, 2014/30/EU,
2011/65/EU&(EU)2015/863

Standards conform to
EN 60335-1, EN 1012-1,
EN 62233, EN 55014-1, EN 55014-2



2022/02/08
Allen Ding
Deputy Chief Engineer, Testing & Certification
Positec Technology (China) Co., Ltd
18, Dongwang Road, Suzhou Industrial
Park, Jiangsu 215123, P. R. China

20V Multi-Function Inflator

WX092 WX092.X

DECLARATION OF CONFORMITY

We,
Positec (UK & Ireland) Ltd.
PO Box 6242, Newbury, RG14 9LT, UK

Declare that the product
Description **Cordless air pump**
Type **WX092 WX092.X (092-designation of machinery, representative of Cordless air pump)**
Function **Inflating**

Complies with the following Directives:
Electrical Equipment (Safety) Regulations 2016
Electromagnetic Compatibility Regulations 2016
The Restriction of the Use of Certain Hazardous Substances in Electrical and Electronic Equipment Regulations

Standards conform to
BS EN 60335-1, BS EN 1012-1, BS EN 62233, BS EN 55014-1, BS EN 55014-2



14
2022/02/08
Allen Ding
Deputy Chief Engineer, Testing & Certification
Positec Technology (China) Co., Ltd
18, Dongwang Road, Suzhou Industrial
Park, Jiangsu 215123, P. R. China



After-sales Service and Application

At www.worx.com you can order spare parts or arrange the collection of a product in need of servicing or repair.

Tel. Service: 0345 202 9679

E-Mail: customerservices@worxtools.com

www.worx.com

Copyright © 2022, Positec. All Rights Reserved.
AR01557901