

SAFETY AND OPERATING MANUAL

ORIGINAL INSTRUCTIONS

20V Cordless Bluetooth Speaker
WX009 WX009.X

TABLE OF CONTENT

1. PRODUCT SAFETY
2. COMPONENT LIST
3. TECHNICAL DATA
4. INTENDED USE
5. OPERATING INSTRUCTIONS
6. MAINTENANCE
7. TROUBLESHOOTING
8. ENVIRONMENTAL PROTECTION
9. DECLARATION OF CONFORMITY

1. PRODUCT SAFETY IMPORTANT SAFETY INSTRUCTIONS

 **WARNING: READ AND UNDERSTAND ALL INSTRUCTIONS.** Failure to follow all instructions listed below may result in electric shock, fire and / or serious personal injury.

Save all warnings and instructions for future reference.

- 1) Do not use this apparatus near water.
- 2) Clean only with dry cloth.
- 3) Do not block any ventilation openings. Install in accordance with the manufacturer's instructions.
- 4) Do not install near any heat sources such as radiators, heat registers, stoves, or other apparatus (including amplifiers) that produce heat.
- 5) Only use attachments/accessories specified by the manufacturer.
- 6) Remove battery pack during lightning storms or when unused for long periods of time.
- 7) Refer all servicing to qualified service personnel. Servicing is required when the apparatus has been damaged in any way, such as power-supply cord or plug is damaged, liquid has been spilled or objects have fallen into the apparatus, the apparatus has been exposed to rain or moisture, does not operate normally, or has been dropped.

SAFETY WARNINGS FOR BATTERY PACK

- a) Do not dismantle, open or shred cells or battery pack.
- b) Do not short-circuit a battery pack. Do not store battery packs haphazardly in a box or drawer where they may short-circuit each other or be short-circuited by conductive materials. When battery pack is not in use, keep it away from other metal objects, like paper clips, coins, keys, nails, screws or other small metal objects, that can make a connection from one terminal to another. Shorting the battery terminals together may cause burns or a fire.
- c) Do not expose battery pack to heat or fire. Avoid storage in direct sunlight.
- d) Do not subject battery pack to mechanical shock.
- e) In the event of battery leaking, do not allow the liquid to come into contact with the skin or eyes. If contact has been made, wash the affected area with copious amounts of water and seek medical advice.
- f) Keep battery pack clean and dry.
- g) Wipe the battery pack terminals with a clean dry cloth if they become dirty.
- h) Battery pack needs to be charged before use. Always refer to this instruction and use the correct charging procedure.
- i) Do not maintain battery pack on charge when not in use.
- j) After extended periods of storage, it may be necessary to charge and discharge the battery pack several times to obtain maximum performance.
- k) Recharge only with the charger specified by WORX. Do not use any charger other than that specifically provided for use with the equipment.
- l) Do not use any battery pack which is not designed for use with the equipment.
- m) Keep battery pack out of the reach of children.
- n) Retain the original product literature for future reference.
- o) Remove the battery from the equipment when not in use.
- p) Dispose of properly.
- q) Do not use battery packs of different manufacture, size or type.
- r) Keep the battery away from microwaves and high pressure.

SAFETY INSTRUCTIONS
FOR EXTERNAL POWER
SUPPLY
GENERAL SAFETY
WARNINGS

WARNING: READ AND UNDERSTAND ALL INSTRUCTIONS. Failure to follow all instructions listed below may result in electric shock, fire and / or serious personal injury
Save all warnings and instructions for future reference.









This appliance can be used by children aged from 8 years and above and persons with reduced physical, sensory or mental capabilities or lack of experience and knowledge if they have been given supervision or instruction concerning use of the appliance in a safe way and understand the hazards involved. Children shall not play with the appliance. Cleaning and user maintenance shall not be made by children without supervision.
If the supply cord is damaged, it must be replaced by the manufacturer, its service agent or similarly qualified persons in order to avoid a hazard.

ADDITIONAL SAFETY
WARNINGS

- a. The outlet should be close to the device and be easily accessible.
- b. Use the device NOT with a damaged connecting cable or case.
- c. Follow the technical data given by the manufacturer if you use the device.
- d. Pull out the plug of the outlet if the device is not used.
- e. Do not use the device for works other than those for which they are designed.
- f. Max. Ambient temperature 45 °C.
- g. The mains connection management of this device cannot be substituted. By damage of the power cable the device has to be thrown away.
- h. The device may not be put out to splashing water, rain or humidity.
- i. Objects with liquids, e.g. vases, should not be put on the device.

SYMBOLS

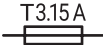
	Read the operator's manual.
---	-----------------------------

	Caution
	Read the operator's manual.
	Batteries may enter water cycle if disposed improperly, which can be hazardous for ecosystem. Do not dispose of waste batteries as unsorted municipal waste.
	Do not burn
	Waste electrical products must not be disposed of with household waste. Please recycle where facilities exist. Check with your local authorities or retailer for recycling advice.
	Li-Ion battery This product has been marked with a symbol relating to 'separate collection' for all battery packs and battery pack. It will then be recycled or dismantled in order to reduce the impact on the environment. Battery packs can be hazardous for the environment and for human health since they contain hazardous substances.
	Fuse
	Double insulation
L.P.S	low power supply
	SMPS (Switch mode power supply unit)



SMPS incorporating a short-circuit-proof safety isolating transformer (inherently or non-inherently)



SMPS incorporating a fail-safe safety isolating transformer



To reduce the risk of fire or electric shock, do not expose this apparatus to rain or moisture

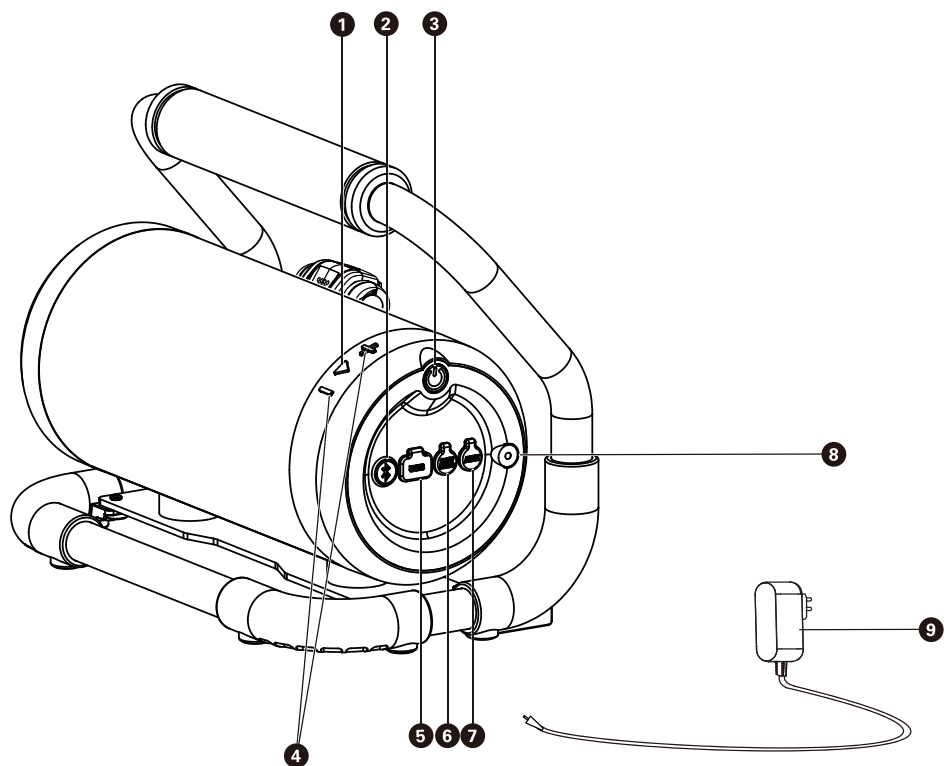

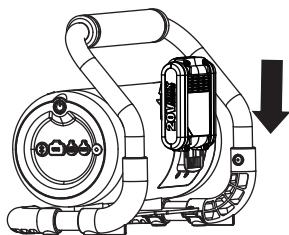
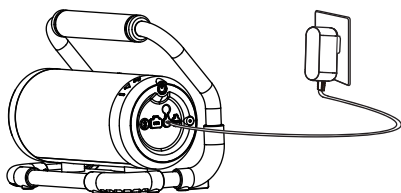
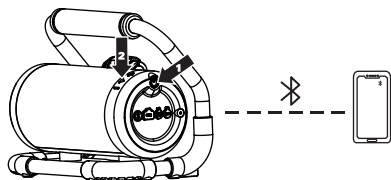
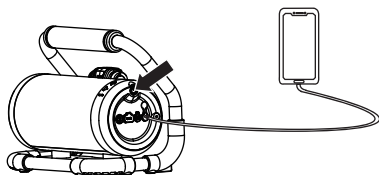
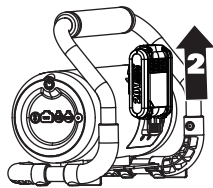
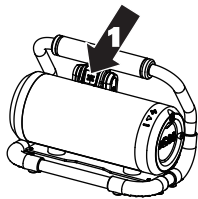
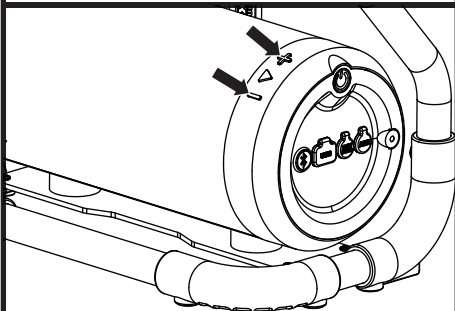
A1**A2****B1****B2****B3****C**

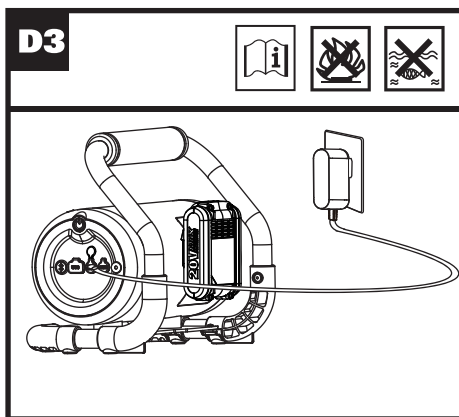
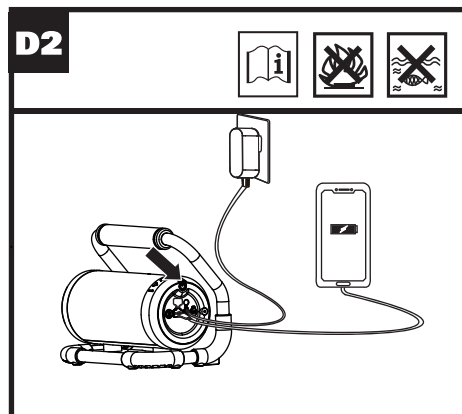
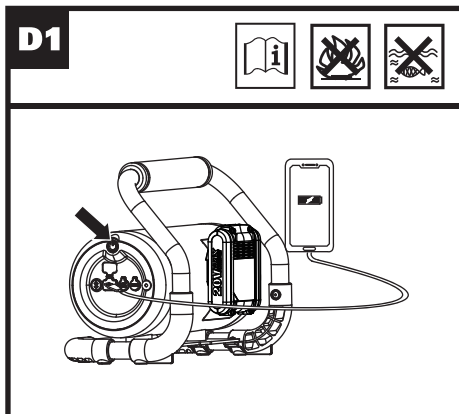

2.COMPONENT LIST

1.	BLUETOOTH BUTTON/PAUSE BUTTON
2.	BLUETOOTH INDICATOR
3.	ON/OFF BUTTON
4.	VOLUME ADJUSTMENT BUTTON
5.	USB POWER PORT
6.	AC-DC PORT
7.	AUX-IN SOCKET
8.	POWER INDICATOR
9.	AC POWER TRANSFORMER*

* Not all the accessories illustrated or described are included in standard delivery.

3.TECHNICAL DATA

Type **WX009 WX009.X (009-designation of machinery, representative of speaker)**

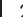
	WX009 WX009.X**	
Rated Voltage	20 V  Max***	
Acoustic system	2*15W +1*10W +1*passive woofer	
Bluetooth version	4.2	
USB output	5 V/1 A	
Operating temperature	0 °C-40 °C	
Storage temperature	-20 °C-40 °C	
AC power transformer* (AP110E-210150)	Input	100-240 V~50/60 Hz
		1.2A
	Output	21 V  1.5 A 31.5 W
Bluetooth name	WORX-BT-SPEAKER-XXXX (X=0-9)	
Max. radio-frequency power	7.93 W	
Machine weight (bare tool)	3.3 kg	

**X=1-999, A-Z, M1-M9 there are only used for different customers, there are no safe relevant changes between these models.

*** Voltage measured without workload. Initial battery voltage reaches maximum of 20 volts.

Nominal voltage is 18 volts.

SUGGESTED BATTERIES

Category	Model	Capacity
20V Battery	WA3551	2.0 Ah

We recommend that you purchase your accessories from the same store that sold you the tool. Refer to the accessory packaging for further details. Store personnel can assist you and offer advice.

4.INTENDED USE

The machine is intended for playing powerful sound.

5.OPERATING INSTRUCTIONS



NOTE: Before using the tool, read the instruction book carefully.

ASSEMBLY AND OPERATION

ACTION	FIGURE
USE AS A SPEAKER	
BEFORE OPERATION	
Mode 1 Install the battery pack to supply power to the speaker.	See Fig. A1
Mode 2 With a AC-DC port, the speaker can be connected to the mains via AC power transformer to supply power to the speaker.	See Fig. A2
Mode 3 Install the battery pack and connect the speaker to the mains via AC power transformer. In this mode, the speaker can be used to play audio and at the same time be used to charge battery pack(See Fig. D3).	
OPERATION	
Playing Audio	

**20V Cordless Bluetooth Speaker
WX009 WX009.X**

<p>Mode 1</p> <p>1. Press the on/off button for 2 seconds to turn on the speaker and the power indicator will become lit. Check Bluetooth function of your audio device and turn on the Bluetooth of the device.</p> <p>2. Find the speaker Bluetooth name on the Bluetooth list of your audio device and get paired with it. If the speaker bluetooth name cannot be found, press the Bluetooth button for 2 seconds and the Bluetooth indicator will blink. Find the speaker Bluetooth name and get paired with it, then the Bluetooth indicator will become lit.</p> <p>3. Play the audio.</p> <p>4. Press the pause button to pause or play.</p> <p>5. Stop audio palying through your audio device. NOTE: Turn off the Bluetooth on your audio device or delete the speaker Bluetooth name on the Bluetooth list of the audio device to stop the Bluetooth connection. NOTE: Keep the speaker Bluetooth on and if the Bluetooth device has been previously paired once, the Bluetooth device can be automatically paired to the speaker when you turn on the speaker.</p>	<p>See Fig. B1</p>	<p>Press the on/off button for 2 seconds to turn off the speaker. Remove the battery pack (See Fig. B3) and/or the AC power transformer. NOTE: Press the battery unlock button when removing the battery pack.</p>	
<p>Mode 2</p> <p>1. Press the on/off button for 2 seconds to turn on the speaker and the power indicator will become lit.</p> <p>2. With the AUX-in socket, the speaker can be connected to the audio device.(The AUX cable is not included in standard delivery.)</p> <p>3. Play the audio. NOTE: In this mode, no Bluetooth connection can be made, and Bluetooth connection can only be made after exiting the Aux mode.</p>	<p>See Fig. B2</p>	<p>Mode 1 Connect the device to the speaker and install the battery pack. Turn on the speaker and the speaker starts to charge the device. NOTE: Charge the battery pack before installing the battery pack to the speaker. When the battery pack voltage drops to the point of under voltage protection, the speaker will stop charging.</p> <p>Mode 2 Connect the device to the speaker and connect the speaker to the mains via AC power transformer. Turn on the speaker and the speaker starts to charge the device.</p>	<p>See Fig. D1</p>
<p>NOTE: Speaker will automatically shut down if no audio is played for 30 minutes after it is turned on.</p>			
<p>AFTER OPERATION</p>			

Adjusting Volume

Adjust the volume by pressing the volume adjustment button "+" / "-".	See Fig. C
---	------------

NOTE: When the battery pack is used for power supply and the battery pack power is low, the power indicator blinks quickly, and the speaker will automatically shut down after the prompt tone.

USE AS A CHARGER

With a USB power port, the speaker can be connected to charge different kinds of devices, such as phones, tablets, etc..
NOTE: The charging cable is not included in standard delivery.
NOTE: The USB power port is NOT designed to play audio files on audio device.
NOTE: Please keep the speaker powered on when it is used as a charger.

<p>Mode 1 Connect the device to the speaker and install the battery pack. Turn on the speaker and the speaker starts to charge the device. NOTE: Charge the battery pack before installing the battery pack to the speaker. When the battery pack voltage drops to the point of under voltage protection, the speaker will stop charging.</p>	<p>See Fig. D1</p>
<p>Mode 2 Connect the device to the speaker and connect the speaker to the mains via AC power transformer. Turn on the speaker and the speaker starts to charge the device.</p>	<p>See Fig. D2</p>

Charging the battery pack

Install the battery pack and connect the speaker to the mains via AC power transformer to charge the battery pack.

NOTE: The speaker can charge the battery pack both when it is on and off.

NOTE: When the speaker is turned on, the power indicator blinks and will become lit when the battery pack is fully charged. When the speaker is off, the power indicator blinks slowly and will get off when the battery pack is fully charged.

The power indicator blinks quickly when the battery pack is defective.

See Fig. D3

6. MAINTENANCE

Remove the power supply before carrying out any servicing or maintenance.

CAUTION: Danger of explosion if battery is incorrectly replaced. Replace only with the same or equivalent type.

Never use water or chemical cleaners to clean your product. Always store your product in a cool and dry place. Keep all working controls free of dust.

7. TROUBLESHOOTING

1. THE SPEAKER CANNOT BE TURNED ON.

- 1) Check whether the battery pack is installed correctly.
- 2) Check whether the AC power transformer is correctly plugged to the mains.
- 3) Check whether the battery pack is out of power.

2. THE SPEAKER CANNOT GET PAIRED WITH THE AUDIO DEVICE.

- 1) Check whether the Bluetooth function of the device is in good situation.
- 2) Check whether the audio device has been paired to another Bluetooth device.
- 3) Check whether there is a device that is causing interference.

8. ENVIRONMENTAL PROTECTION



Waste electrical products must not be disposed of with household waste. Please recycle where facilities exist. Check with your local authorities or retailer for recycling advice.

9. DECLARATION OF CONFORMITY

We,
Positec Germany GmbH
Postfach 32 02 16, 50796 Cologne, Germany

On behalf of Positec declare that the product
Description **20V Cordless Bluetooth Speaker**
Type **WX009 WX009.X (009-designation of machinery, representative of speaker)**
Function **Playing audio**

Complies with the following Directives:
2014/53/EU, 2011/65/EU & (EU)2015/863

Standards conform to
EN IEC 62368-1:2020/A11:2020, EN 62479:2010, EN 301 489-1 V2.2.3, EN 301 489-17 V3.2.4, EN 55032:2015, EN 55035:2017, EN IEC 61000-3-2:2019, EN 61000-3-3:2016+A1:2019, EN 300 328 V2.2.2, Final Draft EN 303 345 V1.1.7

The person authorized to compile the technical file,
Name Marcel Filz
Address Positec Germany GmbH
Postfach 32 02 16, 50796 Cologne, Germany



2022/03/01
Allen Ding
Deputy Chief Engineer, Testing & Certification
Positec Technology (China) Co., Ltd
18, Dongwang Road, Suzhou Industrial
Park, Jiangsu 215123, P. R. China

20V Cordless Bluetooth Speaker
WX009 WX009.X

DECLARATION OF CONFORMITY

We,
Positec (UK & Ireland) Ltd,
PO Box 6242, Newbury, RG14 9LT, UK

On behalf of Positec declare that the product
Description **20V Cordless Bluetooth Speaker**
Type **WX009 WX009.X (009-designation of machinery, representative of speaker)**
Function Playing audio

Complies with the following regulations:
Radio Equipment Regulations 2017
The Restriction of the Use of Certain Hazardous Substances in Electrical and Electronic Equipment Regulations

Standards conform to
EN IEC 62368-1:2020/A11:2020, BS EN 62479:2010,
EN 301 489-1 V2.2.3, EN 301 489-17 V3.2.4, BS EN
55032:2015, BS EN 55035:2017, BS EN IEC 61000-3-
2:2019, BS EN 61000-3-3:2016+A1:2019, EN 300 328
V2.2.2, Final Draft EN 303 345 V1.1.7

The person authorized to compile the technical file,
Name: Jim Kirkwood
Address Positec (UK & Ireland) Ltd,
PO Box 6242, Newbury, RG14 9LT, UK

11



2022/03/01
Allen Ding
Deputy Chief Engineer, Testing & Certification
Positec Technology (China) Co., Ltd
18, Dongwang Road, Suzhou Industrial
Park, Jiangsu 215123, P. R. China

20V Cordless Bluetooth Speaker
WX009 WX009.X



www.worx.com

Copyright © 2022, Positec. All Rights Reserved.